

RAL 7047

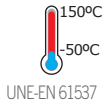

RoHS ✓



CPEFV



CCEFV



CXEFV



CREFV



TEEFV



RIEFV



RCEFV



RDEFV



JUEFV



JUAEFV



JUBEFV



BEFV



CTFV

B		☐							
		H3"		H4"		H6"		H8"	
inch	mm	in ²	cm ²	in ²	cm ²	in ²	cm ²	in ²	cm ²
6	150	10,44	66,30	16,20	102,90	27,02	171,60	39,50	250,80
9	225	15,66	99,45	24,31	154,35	40,54	257,40	59,24	376,20
12	300	20,88	132,60	32,41	205,80	54,05	343,20	78,99	501,60
18	450	31,32	198,90	48,61	308,70	81,07	514,80	118,49	752,40
24	600	41,76	265,20	64,82	411,60	108,09	686,40	157,98	1003,20
30	750	52,20	331,50	81,02	514,50	135,12	858,00	197,48	1254,00
36	900	62,65	397,80	97,23	617,40	162,14	1029,60	236,98	1504,80

NEMA	
EFV 3S	8C/12A
EFV 4S	12C/16A
EFV 6L	20B
EFV 6S	20C
EFV 8S	20C





EFV 3S



EFV 3S-BxH-p
L = 6 m (20ft)

	B		H		PRFV					
					p=6" (150 mm)		p=9" (230 mm)		p=12" (300mm)	
	inch	mm	inch	mm	REF	Kg/m	REF	Kg/m	REF	Kg/m
EFV 3S-6x3-p	6	150	3	75	2/11239	3,03	2/11279	2,74	2/11319	2,62
EFV 3S-9x3-p	9	225	3	75	2/11240	3,43	2/11280	3,01	2/11320	2,82
EFV 3S-12x3-p	12	300	3	75	2/11241	3,83	2/11281	3,27	2/11321	3,03
EFV 3S-18x3-p	18	450	3	75	2/11242	4,64	2/11282	3,79	2/11322	3,43
EFV 3S-24x3-p	24	600	3	75	2/11243	5,45	2/11283	4,32	2/11323	3,84

2 x JUEFV H3 (2/12068)

EFV 3S-6x3-6 --> 2/11239

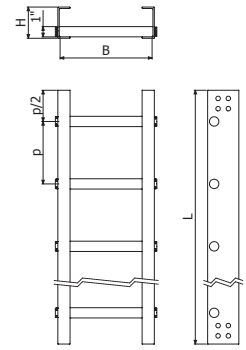

EFV 4S

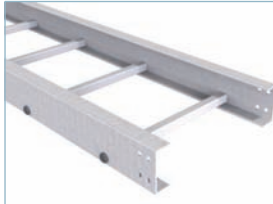

EFV 4S-BxH-p
L = 6 m (20ft)

	B		H		PRFV					
					p=6" (150 mm)		p=9" (230 mm)		p=12" (300mm)	
	inch	mm	inch	mm	REF	Kg/m	REF	Kg/m	REF	Kg/m
EFV 4S-6x4-p	6	150	4	100	2/11244	4,05	2/11284	3,77	2/11324	3,65
EFV 4S-9x4-p	9	225	4	100	2/11245	4,45	2/11285	4,03	2/11325	3,85
EFV 4S-12x4-p	12	300	4	100	2/11246	4,86	2/11286	4,29	2/11326	4,05
EFV 4S-18x4-p	18	450	4	100	2/11247	5,67	2/11287	4,82	2/11327	4,46
EFV 4S-24x4-p	24	600	4	100	2/11248	6,48	2/11288	5,35	2/11328	4,86
EFV 4S-30x4-p	30	750	4	100	2/11249	7,29	2/11289	5,87	2/11329	5,26
EFV 4S-36x4-p	36	900	4	100	2/11250	7,56	2/11290	6,05	2/11330	5,40

2 x JUEFV H4 (2/12069)

EFV 4S-6x4-6 --> 2/11244

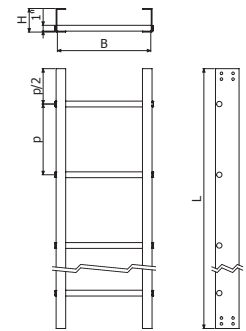

EFV 6L



EFV 6L-BxH-p
L = 6 m (20ft)

	B		H		PRFV					
					p=6" (150 mm)		p=9" (230 mm)		p=12" (300mm)	
	inch	mm	inch	mm	REF	Kg/m	REF	Kg/m	REF	Kg/m
EFV 6L-6x6-p	6	150	6	150	2/11251	5,66	2/11291	5,37	2/11331	5,25
EFV 6L-9x6-p	9	225	6	150	2/11252	6,06	2/11292	5,64	2/11332	5,46
EFV 6L-12x6-p	12	300	6	150	2/11253	6,47	2/11293	5,90	2/11333	5,66
EFV 6L-18x6-p	18	450	6	150	2/11254	7,28	2/11294	6,43	2/11334	6,06
EFV 6L-24x6-p	24	600	6	150	2/11255	8,09	2/11295	6,95	2/11335	6,47
EFV 6L-30x6-p	30	750	6	150	2/11256	8,90	2/11296	7,48	2/11336	6,87
EFV 6L-36x6-p	36	900	6	150	2/11257	9,17	2/11297	7,65	2/11337	7,01

2 x JUEFV H6 (2/12070)

EFV 6L-6x6-6 --> 2/11251

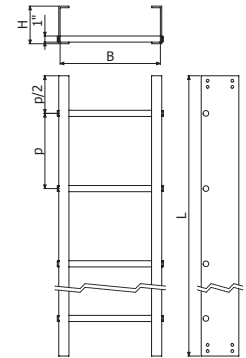

EFV 6S



EFV 6S-BxH-p
L = 6 m (20ft)

	B		H		PRFV					
					p=6" (150 mm)		p=9" (230 mm)		p=12" (300mm)	
	inch	mm	inch	mm	REF	Kg/m	REF	Kg/m	REF	Kg/m
EFV 6S-6x6-p	6	150	6	150	2/11258	7,24	2/11298	6,96	2/11338	6,84
EFV 6S-9x6-p	9	225	6	150	2/11259	7,65	2/11299	7,22	2/11339	7,04
EFV 6S-12x6-p	12	300	6	150	2/11260	8,05	2/11300	7,49	2/11340	7,24
EFV 6S-18x6-p	18	450	6	150	2/11261	8,86	2/11301	8,01	2/11341	7,65
EFV 6S-24x6-p	24	600	6	150	2/11262	9,67	2/11302	8,54	2/11342	8,05
EFV 6S-30x6-p	30	750	6	150	2/11263	10,48	2/11303	9,06	2/11343	8,46
EFV 6S-36x6-p	36	900	6	150	2/11264	10,75	2/11304	9,24	2/11344	8,59

2 x JUEFV H6 (2/12070)

EFV 6S-6x6-6 --> 2/11258

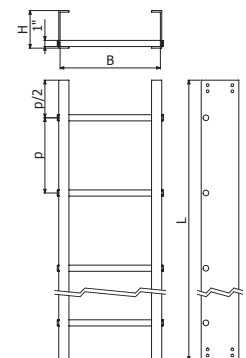



EFV 6R



EFV 6R-BxH-p
L = 6 m (20ft)

	B		H		PRFV					
					p=6" (150 mm)		p=9" (230 mm)		p=12" (300mm)	
	inch	mm	inch	mm	REF	Kg/m	REF	Kg/m	REF	Kg/m
EFV 6R-6x6-p	6	150	6	150	2/11265	8,83	2/11305	8,54	2/11345	8,42
EFV 6R-9x6-p	9	225	6	150	2/11266	9,23	2/11306	8,81	2/11346	8,63
EFV 6R-12x6-p	12	300	6	150	2/11267	9,64	2/11307	9,07	2/11347	8,83
EFV 6R-18x6-p	18	450	6	150	2/11268	10,45	2/11308	9,60	2/11348	9,23
EFV 6R-24x6-p	24	600	6	150	2/11269	11,26	2/11309	10,12	2/11349	9,64
EFV 6R-30x6-p	30	750	6	150	2/11270	12,07	2/11310	10,65	2/11350	10,04
EFV 6R-36x6-p	36	900	6	150	2/11271	12,34	2/11311	10,83	2/11351	10,18

2 x JUEFV H6 (2/12070)

EFV 6R-6x6-6 --> 2/11265

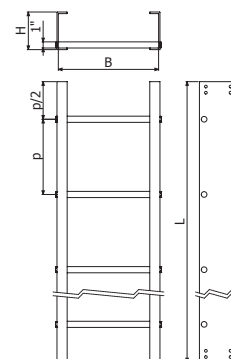

EFV 8S



EFV 8S-BxH-p
L = 6 m (20ft)

	B		H		PRFV					
					p=6" (150 mm)		p=9" (230 mm)		p=12" (300mm)	
	inch	mm	inch	mm	REF	Kg/m	REF	Kg/m	REF	Kg/m
EFV 8S-6x8-p	6	150	8	200	2/11272	8,10	2/11312	7,82	2/11352	7,70
EFV 8S-9x8-p	9	225	8	200	2/11273	8,50	2/11313	8,08	2/11353	7,90
EFV 8S-12x8-p	12	300	8	200	2/11274	8,91	2/11314	8,34	2/11354	8,10
EFV 8S-18x8-p	18	450	8	200	2/11275	9,72	2/11315	8,87	2/11355	8,51
EFV 8S-24x8-p	24	600	8	200	2/11276	10,53	2/11316	9,40	2/11356	8,91
EFV 8S-30x8-p	30	750	8	200	2/11277	11,34	2/11317	9,92	2/11357	9,31
EFV 8S-36x8-p	36	900	8	200	2/11278	11,61	2/11318	10,10	2/11358	9,45

2 x JUEFV H8 (2/12071)

EFV 8S-6x8-6 --> 2/11272

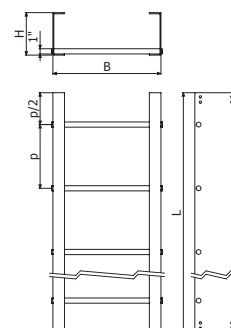

CP - CC - CX (H3)

	R		A (°)	B		H		PRFV					
	inch	mm		inch	mm	inch	mm	CP		CC		CX	
							REF	Kg/ud	REF	Kg/ud	REF	Kg/ud	
	12	300	45	6	150	3	75	2/11359	0,78	2/11495	1,43	2/11631	1,43
	12	300	45	9	230	3	75	2/11360	0,96	2/11496	1,61	2/11632	1,61
	12	300	45	12	300	3	75	2/11361	1,15	2/11497	1,79	2/11633	1,79
	12	300	45	18	450	3	75	2/11362	1,51	2/11498	2,15	2/11634	2,15
	12	300	45	24	600	3	75	2/11363	1,87	2/11499	2,52	2/11635	2,52
	12	300	90	6	150	3	75	2/11364	2,06	2/11500	3,35	2/11636	3,35
	12	300	90	9	230	3	75	2/11365	2,43	2/11501	3,72	2/11637	3,72
	12	300	90	12	300	3	75	2/11366	2,79	2/11502	4,08	2/11638	4,08
	12	300	90	18	450	3	75	2/11367	3,52	2/11503	4,81	2/11639	4,81
	12	300	90	24	600	3	75	2/11368	4,25	2/11504	5,54	2/11640	5,54

2 x JUEFV H3 (2/12068)

CP12-45 EFV-6x3 --> 2/11359

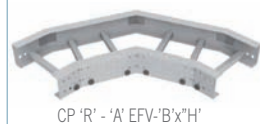

CP 'R' - 'A' EFV-'B'x'H'



CC 'R' - 'A' EFV-'B'x'H'



CX 'R' - 'A' EFV-'B'x'H'

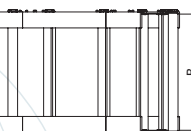
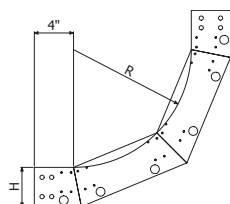

CC 'R' - 'A' EFV-'B'x'H'

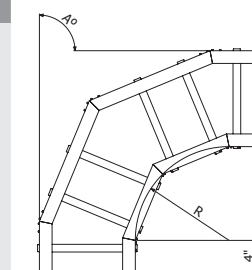
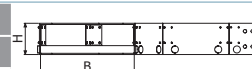

CP 'R' - 'A' EFV-'B'x'H'

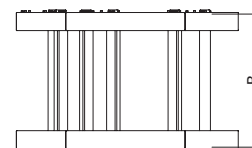
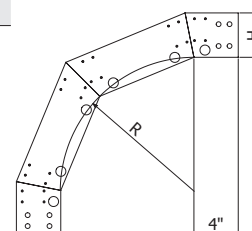

CX 'R' - 'A' EFV-'B'x'H'



CP- CC- CX (H4)

								PRFV					
R		A (°)	B		H		CP		CC		CX		
inch	mm		inch	mm	inch	mm	REF	Kg/ud	REF	Kg/ud	REF	Kg/ud	
	12	300	45	6	150	4	100	2/11369	1,28	2/11505	1,93	2/11641	1,93
	12	300	45	9	225	4	100	2/11370	1,46	2/11506	2,11	2/11642	2,11
	12	300	45	12	300	4	100	2/11371	1,65	2/11507	2,29	2/11643	2,29
	12	300	45	18	450	4	100	2/11372	2,01	2/11508	2,65	2/11644	2,65
	12	300	45	24	600	4	100	2/11373	2,37	2/11509	3,02	2/11645	3,02
	12	300	45	30	750	4	100	2/11374	2,74	2/11510	3,38	2/11646	3,38
	12	300	45	36	900	4	100	2/11375	2,86	2/11511	3,50	2/11647	3,50
	12	300	90	6	150	4	100	2/11376	2,56	2/11512	3,85	2/11648	3,85
	12	300	90	9	225	4	100	2/11377	2,93	2/11513	4,22	2/11649	4,22
	12	300	90	12	300	4	100	2/11378	3,29	2/11514	4,58	2/11650	4,58
	12	300	90	18	450	4	100	2/11379	4,02	2/11515	5,31	2/11651	5,31
	12	300	90	24	600	4	100	2/11380	4,75	2/11516	6,04	2/11652	6,04
	12	300	90	30	750	4	100	2/11381	5,48	2/11517	6,77	2/11653	6,77
	12	300	90	36	900	4	100	2/11382	5,72	2/11518	7,01	2/11654	7,01
	24	600	45	6	150	4	100	2/11383	1,47	2/11519	2,21	2/11655	2,21
	24	600	45	9	225	4	100	2/11384	1,68	2/11520	2,42	2/11656	2,42
	24	600	45	12	300	4	100	2/11385	1,89	2/11521	2,63	2/11657	2,63
	24	600	45	18	450	4	100	2/11386	2,31	2/11522	3,05	2/11658	3,05
	24	600	45	24	600	4	100	2/11387	2,73	2/11523	3,47	2/11659	3,47
	24	600	45	30	750	4	100	2/11388	3,15	2/11524	3,89	2/11660	3,89
	24	600	45	36	900	4	100	2/11389	3,29	2/11525	4,03	2/11661	4,03
	24	600	90	6	150	4	100	2/11390	2,95	2/11526	4,43	2/11662	4,43
	24	600	90	9	225	4	100	2/11391	3,36	2/11527	4,85	2/11663	4,85
	24	600	90	12	300	4	100	2/11392	3,78	2/11528	5,27	2/11664	5,27
	24	600	90	18	450	4	100	2/11393	4,62	2/11529	6,10	2/11665	6,10
	24	600	90	24	600	4	100	2/11394	5,46	2/11530	6,94	2/11666	6,94
	24	600	90	30	750	4	100	2/11395	6,30	2/11531	7,78	2/11667	7,78
	24	600	90	36	900	4	100	2/11396	6,58	2/11532	8,06	2/11668	8,06
	36	900	45	6	150	4	100	2/11397	1,69	2/11533	2,55	2/11669	2,55
	36	900	45	9	225	4	100	2/11398	1,93	2/11534	2,79	2/11670	2,79
	36	900	45	12	300	4	100	2/11399	2,18	2/11535	3,03	2/11671	3,03
	36	900	45	18	450	4	100	2/11400	2,66	2/11536	3,51	2/11672	3,51
	36	900	45	24	600	4	100	2/11401	3,14	2/11537	3,99	2/11673	3,99
	36	900	45	30	750	4	100	2/11402	3,62	2/11538	4,47	2/11674	4,47
	36	900	45	36	900	4	100	2/11403	3,78	2/11539	4,63	2/11675	4,63
	36	900	90	6	150	4	100	2/11404	3,39	2/11540	5,09	2/11676	5,09
36	900	90	9	225	4	100	2/11405	3,87	2/11541	5,58	2/11677	5,58	
36	900	90	12	300	4	100	2/11406	4,35	2/11542	6,06	2/11678	6,06	
36	900	90	18	450	4	100	2/11407	5,31	2/11543	7,02	2/11679	7,02	
36	900	90	24	600	4	100	2/11408	6,28	2/11544	7,98	2/11680	7,98	
36	900	90	30	750	4	100	2/11409	7,24	2/11545	8,95	2/11681	8,95	
36	900	90	36	900	4	100	2/11410	7,56	2/11546	9,27	2/11682	9,27	

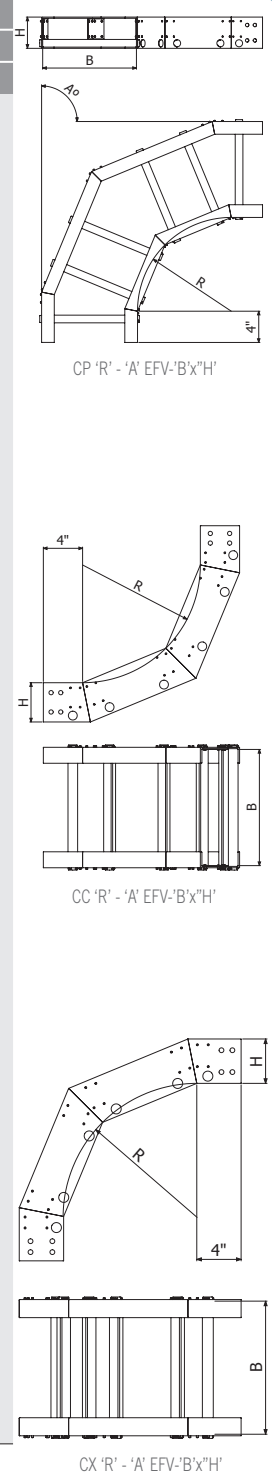

2 x JUEFV H4 (2/12069)
 CP12-45 EFV-6x4 --> 2/11369



CP - CC - CX (H6)

	R		A (°)	B		H		PRFV					
	inch	mm		inch	mm	inch	mm	CP		CC		CX	
								REF	Kg/ud	REF	Kg/ud	REF	Kg/ud
	12	300	45	6	150	6	150	2/11411	2,43	2/11547	3,08	2/11683	3,08
	12	300	45	9	225	6	150	2/11412	2,61	2/11548	3,26	2/11684	3,26
	12	300	45	12	300	6	150	2/11413	2,80	2/11549	3,44	2/11685	3,44
	12	300	45	18	450	6	150	2/11414	3,16	2/11550	3,80	2/11686	3,80
	12	300	45	24	600	6	150	2/11415	3,52	2/11551	4,17	2/11687	4,17
	12	300	45	30	750	6	150	2/11416	3,89	2/11552	4,53	2/11688	4,53
	12	300	45	36	900	6	150	2/11417	4,01	2/11553	4,65	2/11689	4,65
	12	300	90	6	150	6	150	2/11418	3,71	2/11554	5,00	2/11690	5,00
	12	300	90	9	225	6	150	2/11419	4,08	2/11555	5,37	2/11691	5,37
	12	300	90	12	300	6	150	2/11420	4,44	2/11556	5,73	2/11692	5,73
	12	300	90	18	450	6	150	2/11421	5,17	2/11557	6,46	2/11693	6,46
	12	300	90	24	600	6	150	2/11422	5,90	2/11558	7,19	2/11694	7,19
12	300	90	30	750	6	150	2/11423	6,63	2/11559	7,92	2/11695	7,92	
12	300	90	36	900	6	150	2/11424	2,80	2/11560	3,54	2/11696	3,54	
24	600	45	6	150	6	150	2/11425	3,00	2/11561	3,75	2/11697	3,75	
24	600	45	9	225	6	150	2/11426	3,21	2/11562	3,96	2/11698	3,96	
24	600	45	12	300	6	150	2/11427	3,63	2/11563	4,37	2/11699	4,37	
24	600	45	18	450	6	150	2/11428	4,05	2/11564	4,79	2/11700	4,79	
24	600	45	24	600	6	150	2/11429	4,47	2/11565	5,21	2/11701	5,21	
24	600	45	30	750	6	150	2/11430	4,61	2/11566	5,35	2/11702	5,35	
24	600	45	36	900	6	150	2/11431	4,27	2/11567	5,75	2/11703	5,75	
24	600	90	6	150	6	150	2/11432	4,69	2/11568	6,17	2/11704	6,17	
24	600	90	9	225	6	150	2/11433	5,11	2/11569	6,59	2/11705	6,59	
24	600	90	12	300	6	150	2/11434	5,94	2/11570	7,43	2/11706	7,43	
24	600	90	18	450	6	150	2/11435	6,78	2/11571	8,27	2/11707	8,27	
24	600	90	24	600	6	150	2/11436	7,62	2/11572	9,10	2/11708	9,10	
24	600	90	30	750	6	150	2/11437	3,21	2/11573	4,07	2/11709	4,07	
24	600	90	36	900	6	150	2/11438	3,46	2/11574	4,31	2/11710	4,31	
36	900	45	6	150	6	150	2/11439	3,21	2/11575	4,07	2/11711	4,07	
36	900	45	9	225	6	150	2/11440	3,46	2/11576	4,31	2/11712	4,31	
36	900	45	12	300	6	150	2/11441	3,70	2/11577	4,55	2/11713	4,55	
36	900	45	18	450	6	150	2/11442	4,18	2/11578	5,03	2/11714	5,03	
36	900	45	24	600	6	150	2/11443	4,66	2/11579	5,51	2/11715	5,51	
36	900	45	30	750	6	150	2/11444	5,14	2/11580	5,99	2/11716	5,99	
36	900	45	36	900	6	150	2/11445	5,30	2/11581	6,16	2/11717	6,16	
36	900	90	6	150	6	150	2/11446	4,91	2/11582	6,61	2/11718	6,61	
36	900	90	9	225	6	150	2/11447	5,39	2/11583	7,10	2/11719	7,10	
36	900	90	12	300	6	150	2/11448	5,87	2/11584	7,58	2/11720	7,58	
36	900	90	18	450	6	150	2/11449	6,84	2/11585	8,54	2/11721	8,54	
36	900	90	24	600	6	150	2/11450	7,80	2/11586	9,50	2/11722	9,50	
36	900	90	30	750	6	150	2/11451	8,76	2/11587	10,47	2/11723	10,47	
36	900	90	36	900	6	150	2/11452	3,70	2/11588	4,68	2/11724	4,68	

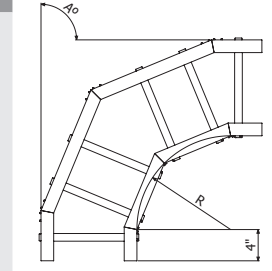
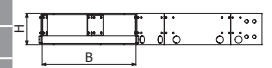

CP 'R' - 'A' EFV-'B'x'H'

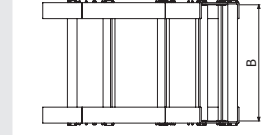
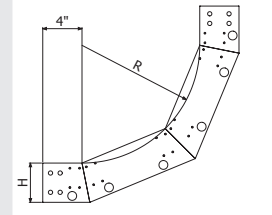

CC 'R' - 'A' EFV-'B'x'H'

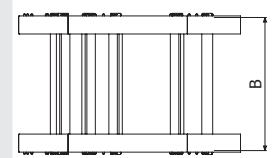
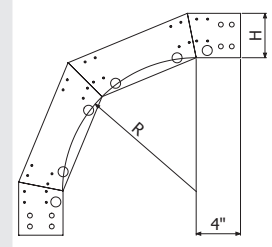

CX 'R' - 'A' EFV-'B'x'H'

2 x JUEFV H6 (2/12070)

CP12-45 EFV-6x6 --> 2/11411



CP - CC - CX (H8)

	R		A (°)	B		H		PRFV					
	inch	mm		inch	mm	inch	mm	CP		CC		CX	
								REF	Kg/ud	REF	Kg/ud	REF	Kg/ud
	12	300	45	6	150	8	200	2/11453	3,76	2/11589	4,41	2/11725	4,41
	12	300	45	9	225	8	200	2/11454	3,94	2/11590	4,59	2/11726	4,59
	12	300	45	12	300	8	200	2/11455	4,13	2/11591	4,77	2/11727	4,77
	12	300	45	18	450	8	200	2/11456	4,49	2/11592	5,13	2/11728	5,13
	12	300	45	24	600	8	200	2/11457	4,85	2/11593	5,50	2/11729	5,50
	12	300	45	30	750	8	200	2/11458	5,22	2/11594	5,86	2/11730	5,86
	12	300	45	36	900	8	200	2/11459	5,34	2/11595	5,98	2/11731	5,98
	12	300	90	6	150	8	200	2/11460	5,04	2/11596	6,33	2/11732	6,33
	12	300	90	9	225	8	200	2/11461	5,41	2/11597	6,70	2/11733	6,70
	12	300	90	12	300	8	200	2/11462	5,77	2/11598	7,06	2/11734	7,06
	12	300	90	18	450	8	200	2/11463	6,50	2/11599	7,79	2/11735	7,79
	12	300	90	24	600	8	200	2/11464	7,23	2/11600	8,52	2/11736	8,52
	12	300	90	30	750	8	200	2/11465	7,96	2/11601	9,25	2/11737	9,25
	12	300	90	36	900	8	200	2/11466	4,13	2/11602	4,87	2/11738	4,87
	24	600	45	6	150	8	200	2/11467	4,32	2/11603	5,07	2/11739	5,07
	24	600	45	9	225	8	200	2/11468	4,53	2/11604	5,28	2/11740	5,28
	24	600	45	12	300	8	200	2/11469	4,74	2/11605	5,49	2/11741	5,49
	24	600	45	18	450	8	200	2/11470	5,16	2/11606	5,90	2/11742	5,90
	24	600	45	24	600	8	200	2/11471	5,58	2/11607	6,32	2/11743	6,32
	24	600	45	30	750	8	200	2/11472	6,00	2/11608	6,74	2/11744	6,74
	24	600	45	36	900	8	200	2/11473	6,14	2/11609	6,88	2/11745	6,88
	24	600	90	6	150	8	200	2/11474	5,80	2/11610	7,28	2/11746	7,28
	24	600	90	9	225	8	200	2/11475	6,22	2/11611	7,70	2/11747	7,70
	24	600	90	12	300	8	200	2/11476	6,64	2/11612	8,12	2/11748	8,12
	24	600	90	18	450	8	200	2/11477	7,47	2/11613	8,96	2/11749	8,96
	24	600	90	24	600	8	200	2/11478	8,31	2/11614	9,79	2/11750	9,79
	24	600	90	30	750	8	200	2/11479	9,15	2/11615	10,63	2/11751	10,63
	24	600	90	36	900	8	200	2/11480	4,74	2/11616	5,60	2/11752	5,60
	36	900	45	6	150	8	200	2/11481	4,97	2/11617	5,83	2/11753	5,83
	36	900	45	9	225	8	200	2/11482	5,21	2/11618	6,07	2/11754	6,07
	36	900	45	12	300	8	200	2/11483	5,46	2/11619	6,31	2/11755	6,31
	36	900	45	18	450	8	200	2/11484	5,94	2/11620	6,79	2/11756	6,79
	36	900	45	24	600	8	200	2/11485	6,42	2/11621	7,27	2/11757	7,27
	36	900	45	30	750	8	200	2/11486	6,90	2/11622	7,75	2/11758	7,75
	36	900	45	36	900	8	200	2/11487	7,06	2/11623	7,91	2/11759	7,91
	36	900	90	6	150	8	200	2/11488	6,67	2/11624	8,37	2/11760	8,37
36	900	90	9	225	8	200	2/11489	7,15	2/11625	8,86	2/11761	8,86	
36	900	90	12	300	8	200	2/11490	7,63	2/11626	9,34	2/11762	9,34	
36	900	90	18	450	8	200	2/11491	8,59	2/11627	10,30	2/11763	10,30	
36	900	90	24	600	8	200	2/11492	9,56	2/11628	11,26	2/11764	11,26	
36	900	90	30	750	8	200	2/11493	10,52	2/11629	12,23	2/11765	12,23	
36	900	90	36	900	8	200	2/11494	5,46	2/11630	6,44	2/11766	6,44	

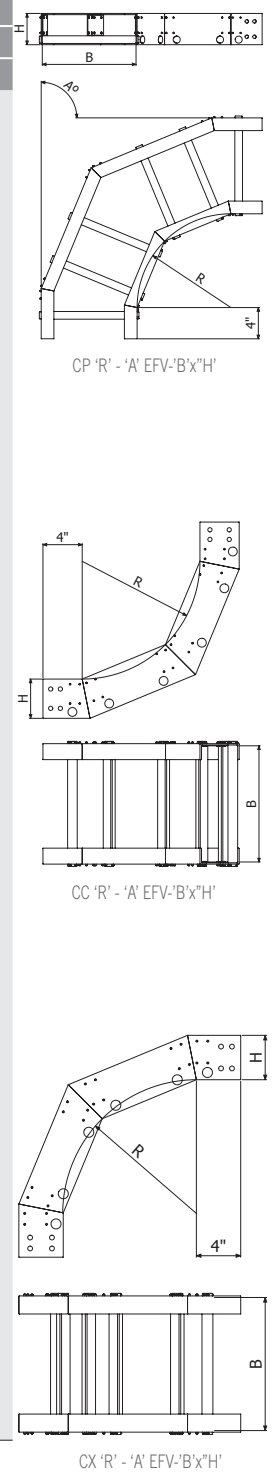

2 x JUEFV H8 (2/12071)
 CP12-45 EFV-6x8 --> 2/11453



TE - CR (H3 - H4)

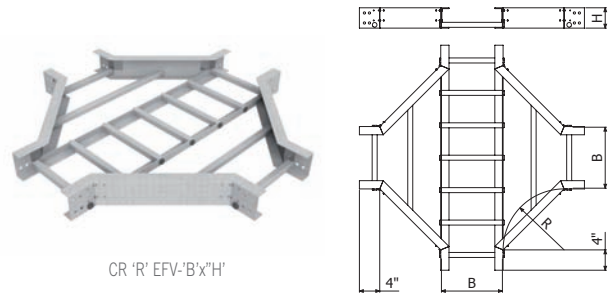
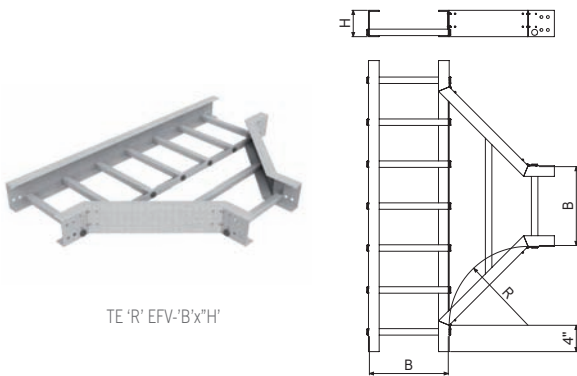

TE 'R' EFV-'B'x'H'

CR 'R' EFV-'B'x'H'

H3	R		B		H		PRFV			
							TE		CR	
	inch	mm	inch	mm	inch	mm	REF	Kg/ud	REF	Kg/ud
	12	300	6	150	3	75	2/11767	5,58	2/11838	6,69
	12	300	9	225	3	75	2/11768	6,06	2/11839	7,48
	12	300	12	300	3	75	2/11769	6,55	2/11840	8,27
	12	300	18	450	3	75	2/11770	7,52	2/11841	9,85
	12	300	24	600	3	75	2/11771	8,49	2/11842	11,43

2 x JUEFV H3 (2/12068)

TE12 EFV-6x3 --> 2/11767

H4	R		B		H		PRFV			
							TE		CR	
	inch	mm	inch	mm	inch	mm	REF	Kg/ud	REF	Kg/ud
	12	300	6	150	4	100	2/11772	6,33	2/11843	7,64
	12	300	9	225	4	100	2/11773	6,81	2/11844	8,43
	12	300	12	300	4	100	2/11774	7,30	2/11845	9,22
	12	300	18	450	4	100	2/11775	8,27	2/11846	10,80
	12	300	24	600	4	100	2/11776	9,24	2/11847	12,38
	12	300	30	750	4	100	2/11777	10,21	2/11848	13,96
	12	300	36	900	4	100	2/11778	10,54	2/11849	14,48
	24	600	6	150	4	100	2/11779	7,28	2/11850	8,79
	24	600	9	225	4	100	2/11780	7,84	2/11851	9,70
	24	600	12	300	4	100	2/11781	8,40	2/11852	10,60
	24	600	18	450	4	100	2/11782	9,51	2/11853	12,42
	24	600	24	600	4	100	2/11783	10,63	2/11854	14,23
	24	600	30	750	4	100	2/11784	11,75	2/11855	16,05
	24	600	36	900	4	100	2/11785	12,12	2/11856	16,65
	36	900	6	150	4	100	2/11786	8,37	2/11857	10,11
	36	900	9	225	4	100	2/11787	9,01	2/11858	11,15
	36	900	12	300	4	100	2/11788	9,65	2/11859	12,19
	36	900	18	450	4	100	2/11789	10,94	2/11860	14,28
	36	900	24	600	4	100	2/11790	12,22	2/11861	16,37
	36	900	30	750	4	100	2/11791	13,51	2/11862	18,46
	36	900	36	900	4	100	2/11792	13,94	2/11863	19,15

2 x JUEFV H4 (2/12069)

TE12 EFV-6x4 --> 2/11772



TE - CR (H6 - H8)

H6							PRFV			
	R		B		H		TE		CR	
	inch	mm	inch	mm	inch	mm	REF	Kg/ud	REF	Kg/ud
12	300	300	6	150	6	150	2/11793	7,83	2/11864	9,14
12	300	300	9	225	6	150	2/11794	8,31	2/11865	9,93
12	300	300	12	300	6	150	2/11795	8,80	2/11866	10,72
12	300	300	18	450	6	150	2/11796	9,77	2/11867	12,30
12	300	300	24	600	6	150	2/11797	10,74	2/11868	13,88
12	300	300	30	750	6	150	2/11798	11,71	2/11869	15,46
12	300	300	36	900	6	150	2/11799	12,04	2/11870	15,98
24	600	600	6	150	6	150	2/11800	8,78	2/11871	10,29
24	600	600	9	225	6	150	2/11801	9,34	2/11872	11,20
24	600	600	12	300	6	150	2/11802	9,90	2/11873	12,10
24	600	600	18	450	6	150	2/11806	11,01	2/11874	13,92
24	600	600	24	600	6	150	2/11807	12,13	2/11875	15,73
24	600	600	30	750	6	150	2/11808	13,25	2/11876	17,55
24	600	600	36	900	6	150	2/11809	13,62	2/11877	18,15
36	900	900	6	150	6	150	2/11810	9,87	2/11878	11,61
36	900	900	9	225	6	150	2/11811	10,51	2/11879	12,65
36	900	900	12	300	6	150	2/11812	11,15	2/11880	13,69
36	900	900	18	450	6	150	2/11813	12,44	2/11881	15,78
36	900	900	24	600	6	150	2/11814	13,72	2/11882	17,87
36	900	900	30	750	6	150	2/11815	15,01	2/11883	19,96
36	900	900	36	900	6	150	2/11816	15,44	2/11884	20,65

2 x JUEFV H6 (2/12070)

TE12 EFV-6x6 --> 2/11793

H8							PRFV			
	R		B		H		TE		CR	
	inch	mm	inch	mm	inch	mm	REF	Kg/ud	REF	Kg/ud
12	300	300	6	150	8	200	2/11817	9,33	2/11885	10,64
12	300	300	9	225	8	200	2/11818	9,81	2/11886	11,43
12	300	300	12	300	8	200	2/11819	10,30	2/11887	12,22
12	300	300	18	450	8	200	2/11820	11,27	2/11888	13,80
12	300	300	24	600	8	200	2/11821	12,24	2/11889	15,38
12	300	300	30	750	8	200	2/11822	13,21	2/11890	16,96
12	300	300	36	900	8	200	2/11823	13,54	2/11891	17,48
24	600	600	6	150	8	200	2/11824	10,28	2/11892	11,79
24	600	600	9	225	8	200	2/11825	10,84	2/11893	12,70
24	600	600	12	300	8	200	2/11826	11,40	2/11894	13,60
24	600	600	18	450	8	200	2/11827	12,51	2/11895	15,42
24	600	600	24	600	8	200	2/11828	13,63	2/11896	17,23
24	600	600	30	750	8	200	2/11829	14,75	2/11897	19,05
24	600	600	36	900	8	200	2/11830	15,12	2/11898	19,65
36	900	900	6	150	8	200	2/11831	11,37	2/11899	13,11
36	900	900	9	225	8	200	2/11832	12,01	2/11900	14,15
36	900	900	12	300	8	200	2/11833	12,65	2/11901	15,19
36	900	900	18	450	8	200	2/11834	13,94	2/11902	17,28
36	900	900	24	600	8	200	2/11835	15,22	2/11903	19,37
36	900	900	30	750	8	200	2/11836	16,51	2/11904	21,46
36	900	900	36	900	8	200	2/11837	16,94	2/11905	22,15

2 x JUEFV H8 (2/12071)

TE12 EFV-6x8 --> 2/11817



RE (H3, H4)

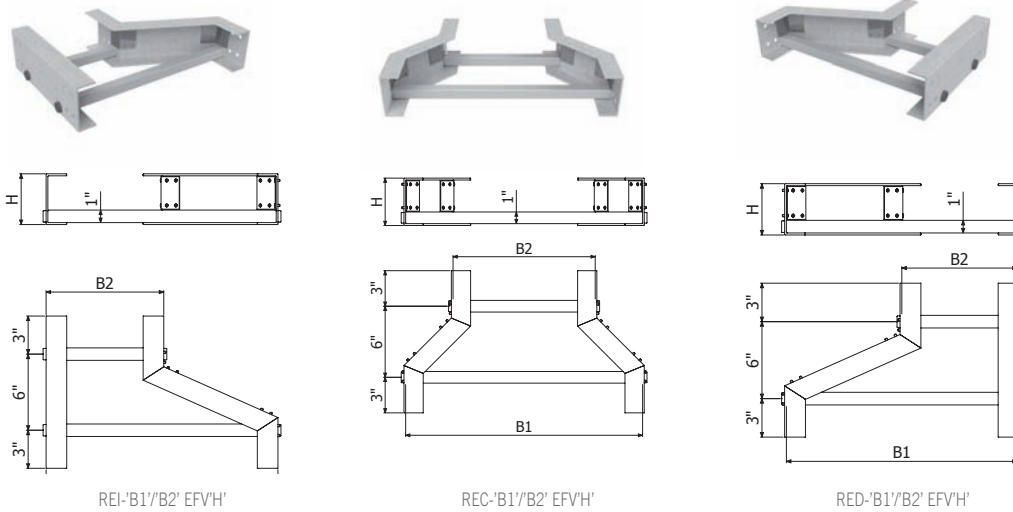

REI-B1/B2' EFV'H'

REC-B1/B2' EFV'H'

RED-B1/B2' EFV'H'

H3	PRFV											
	B1		B2		H		REI		REC		RED	
	inch	mm	inch	mm	inch	mm	REF	Kg/ud	REF	Kg/ud	REF	Kg/ud
9	225	6	100	3	75	2/11906	1,45	2/11960	1,61	2/12014	1,45	
12	300	9	225	3	75	2/11907	1,57	2/11961	1,73	2/12015	1,57	
12	300	6	100	3	75	2/11908	1,51	2/11962	1,67	2/12016	1,51	
18	450	12	300	3	75	2/11909	1,76	2/11963	1,92	2/12017	1,76	
18	450	9	225	3	75	2/11910	1,70	2/11964	1,86	2/12018	1,70	
18	450	6	100	3	75	2/11911	1,64	2/11965	1,80	2/12019	1,64	
24	600	18	450	3	75	2/11912	2,00	2/11966	2,16	2/12020	2,00	
24	600	12	300	3	75	2/11913	1,88	2/11967	2,04	2/12021	1,88	
24	600	9	225	3	75	2/11914	1,82	2/11968	1,98	2/12022	1,82	

2 x JUEFV H3 (2/12068)

REI-9/6 EFV3 --> 2/11906
REC-9/6 EFV3 --> 2/11960
RED-9/6 EFV3 --> 2/12014

H4	PRFV											
	B1		B2		H		REI		REC		RED	
	inch	mm	inch	mm	inch	mm	REF	Kg/ud	REF	Kg/ud	REF	Kg/ud
9	225	6	100	4	100	2/11915	1,70	2/11969	1,86	2/12023	1,70	
12	300	9	225	4	100	2/11916	1,82	2/11970	1,98	2/12024	1,82	
12	300	6	100	4	100	2/11917	1,76	2/11971	1,92	2/12025	1,76	
18	450	12	300	4	100	2/11918	2,01	2/11972	2,17	2/12026	2,01	
18	450	9	225	4	100	2/11919	1,95	2/11973	2,11	2/12027	1,95	
18	450	6	100	4	100	2/11920	1,89	2/11974	2,05	2/12028	1,89	
24	600	18	450	4	100	2/11921	2,25	2/11975	2,41	2/12029	2,25	
24	600	12	300	4	100	2/11922	2,13	2/11976	2,29	2/12030	2,13	
24	600	9	225	4	100	2/11923	2,07	2/11977	2,23	2/12031	2,07	
30	750	24	600	4	100	2/11924	2,49	2/11978	2,65	2/12032	2,49	
30	750	18	450	4	100	2/11925	2,37	2/11979	2,53	2/12033	2,37	
30	750	12	300	4	100	2/11926	2,25	2/11980	2,41	2/12034	2,25	
36	900	30	750	4	100	2/11927	2,65	2/11981	2,81	2/12035	2,65	
36	900	24	600	4	100	2/11928	2,53	2/11982	2,69	2/12036	2,53	
36	900	18	450	4	100	2/11929	2,41	2/11983	2,57	2/12037	2,41	

2 x JUEFV H4 (2/12069)

REI-9/6 EFV4 --> 2/11915
REC-9/6 EFV4 --> 2/11969
RED-9/6 EFV4 --> 2/12023



RE (H6, H8)

H6	B1		B2		H		PRFV					
	inch	mm	inch	mm	inch	mm	REI		REC		RED	
							REF	Kg/ud	REF	Kg/ud	REF	Kg/ud
9	225	6	100	6	150	2/11930	2,20	2/11984	2,36	2/12038	2,20	
12	300	9	225	6	150	2/11931	2,32	2/11985	2,48	2/12039	2,32	
12	300	6	100	6	150	2/11932	2,26	2/11986	2,42	2/12040	2,26	
18	450	12	300	6	150	2/11933	2,51	2/11987	2,67	2/12041	2,51	
18	450	9	225	6	150	2/11934	2,45	2/11988	2,61	2/12042	2,45	
18	450	6	100	6	150	2/11935	2,39	2/11989	2,55	2/12043	2,39	
24	600	18	450	6	150	2/11936	2,75	2/11990	2,91	2/12044	2,75	
24	600	12	300	6	150	2/11937	2,63	2/11991	2,79	2/12045	2,63	
24	600	9	225	6	150	2/11938	2,57	2/11992	2,73	2/12046	2,57	
30	750	24	600	6	150	2/11939	2,99	2/11993	3,15	2/12047	2,99	
30	750	18	450	6	150	2/11940	2,87	2/11994	3,03	2/12048	2,87	
30	750	12	300	6	150	2/11941	2,75	2/11995	2,91	2/12049	2,75	
36	900	30	750	6	150	2/11942	3,15	2/11996	3,31	2/12050	3,15	
36	900	24	600	6	150	2/11943	3,03	2/11997	3,19	2/12051	3,03	
36	900	18	450	6	150	2/11944	2,91	2/11998	3,07	2/12052	2,91	



2 x JUEFV H6 (2/12070)



REI-9/6 EFV6 --> 2/11930
 REC-9/6 EFV6 --> 2/11984
 RED-9/6 EFV6 --> 2/12038

H8	B1		B2		H		PRFV					
	inch	mm	inch	mm	inch	mm	REI		REC		RED	
							REF	Kg/ud	REF	Kg/ud	REF	Kg/ud
9	225	6	100	8	200	2/11945	2,70	2/11999	2,86	2/12053	2,70	
12	300	9	225	8	200	2/11946	2,82	2/12000	2,98	2/12054	2,82	
12	300	6	100	8	200	2/11947	2,76	2/12001	2,92	2/12055	2,76	
18	450	12	300	8	200	2/11948	3,01	2/12002	3,17	2/12056	3,01	
18	450	9	225	8	200	2/11949	2,95	2/12003	3,11	2/12057	2,95	
18	450	6	100	8	200	2/11950	2,89	2/12004	3,05	2/12058	2,89	
24	600	18	450	8	200	2/11951	3,25	2/12005	3,41	2/12059	3,25	
24	600	12	300	8	200	2/11952	3,13	2/12006	3,29	2/12060	3,13	
24	600	9	225	8	200	2/11953	3,07	2/12007	3,23	2/12061	3,07	
30	750	24	600	8	200	2/11954	3,49	2/12008	3,65	2/12062	3,49	
30	750	18	450	8	200	2/11955	3,37	2/12009	3,53	2/12063	3,37	
30	750	12	300	8	200	2/11956	3,25	2/12010	3,41	2/12064	3,25	
36	900	30	750	8	200	2/11957	3,65	2/12011	3,81	2/12065	3,65	
36	900	24	600	8	200	2/11958	3,53	2/12012	3,69	2/12066	3,53	
36	900	18	450	8	200	2/11959	3,41	2/12013	3,57	2/12067	3,41	



2 x JUEFV H8 (2/12071)



REI-9/6 EFV8 --> 2/11945
 REC-9/6 EFV8 --> 2/11999
 RED-9/6 EFV8 --> 2/12053



JUEFV



	H		PRFV	
	inch	mm	REF.	Kg/m
JUEFV H3	3	75	2/12068	0,01
JUEFV H4	4	100	2/12069	0,01
JUEFV H6	6	150	2/12070	0,02
JUEFV H8	8	200	2/12071	0,03

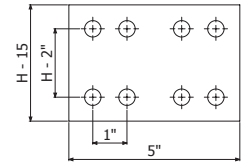

8 x CTFV (2/6386)

JUEFV-A



	H		i316	
	inch	mm	REF.	kg/ud
JUEFV-A H3	3	75	2/12072	0,16
JUEFV-A H4	4	100	2/12073	0,21
JUEFV-A H6	6	150	2/12074	0,36
JUEFV-A H8	8	200	2/12075	0,48

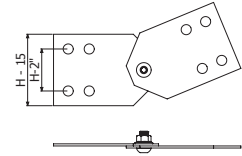

8 x CTFV (2/6386)

JUEFV-B



	H		i316	
	inch	mm	REF.	kg/ud
JUEFV-B H3	3	75	2/12076	0,21
JUEFV-B H4	4	100	2/12077	0,32
JUEFV-B H6	6	150	2/12078	0,57
JUEFV-B H8	8	200	2/12079	0,81

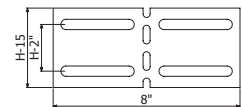

8 x CTFV (2/6386)

BEFV



	e	i316	
		mm	kg/ud
BEFV	3	2/5399	0,04

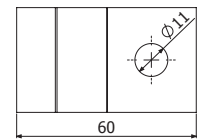
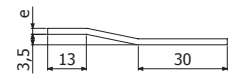

CTFV



	Pap Nm	i316	
		REF.	kg/ud
CTFV M8x20	15	2/6386	0,15

1 x CTFV = 1 x M8x20 ISO7380 + 2 x M8 DIN125 + 1 x M8 DIN934

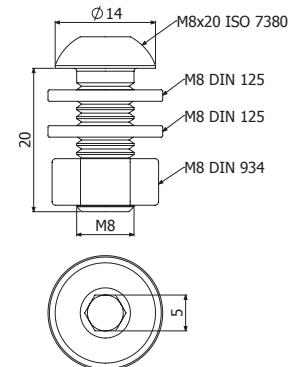



TEFV



	B		e	PRFV	
	inch	mm	mm	REF.	kg/m
TEFV 6	6	150	4	2/14463	1,46
TEFV 9	9	225	4	2/14464	2,20
TEFV 12	12	300	4	2/14465	2,93
TEFV 18	18	450	4	2/14466	4,39
TEFV 24	24	600	4	2/14467	5,86
TEFV 30	30	750	4	2/14468	7,32
TEFV 36	36	900	4	2/14469	8,78

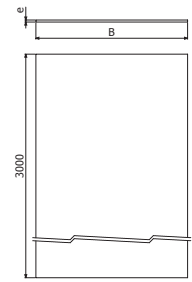

PTEFV



PTEFV H3 - H6



PTEFV H8

	H		PRFV		i316	
	inch	mm	REF.	kg/m	REF.	kg/ud
PTEFV H3	3	75	2/5505	0,06	-	-
PTEFV H4	4	100	2/5506	0,10	-	-
PTEFV H6	6	150	2/14470	0,14	-	-
PTEFV H8	8	200	-	-	2/14471	0,10

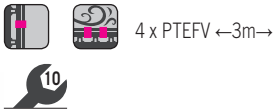

4 x PTEFV ←3m→

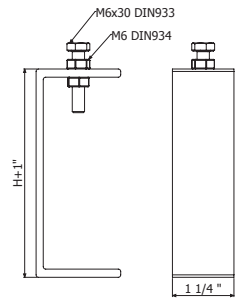

PTEFV H3

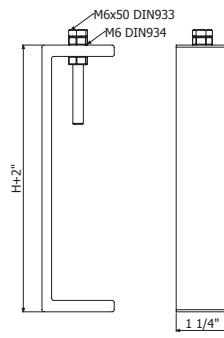

PTEFV H4/H6

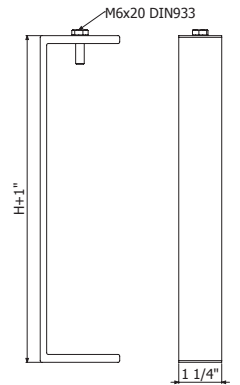

PTEFV H8